

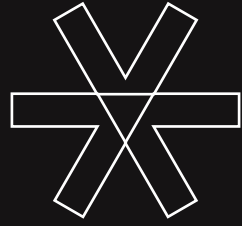

Retail

HUB**VICTORIA**



At the heart of a thriving retail and leisure destination

The HUB is surrounded by world class brands, experiences and amenities and sees very high footfall being adjacent to Victoria Station.

Introduction

Your Neighbourhood

Site Plan

Retail Units

Contact





Introduction

Your Neighbourhood

Location

Area Map

Site Plan

Retail Units

Contact

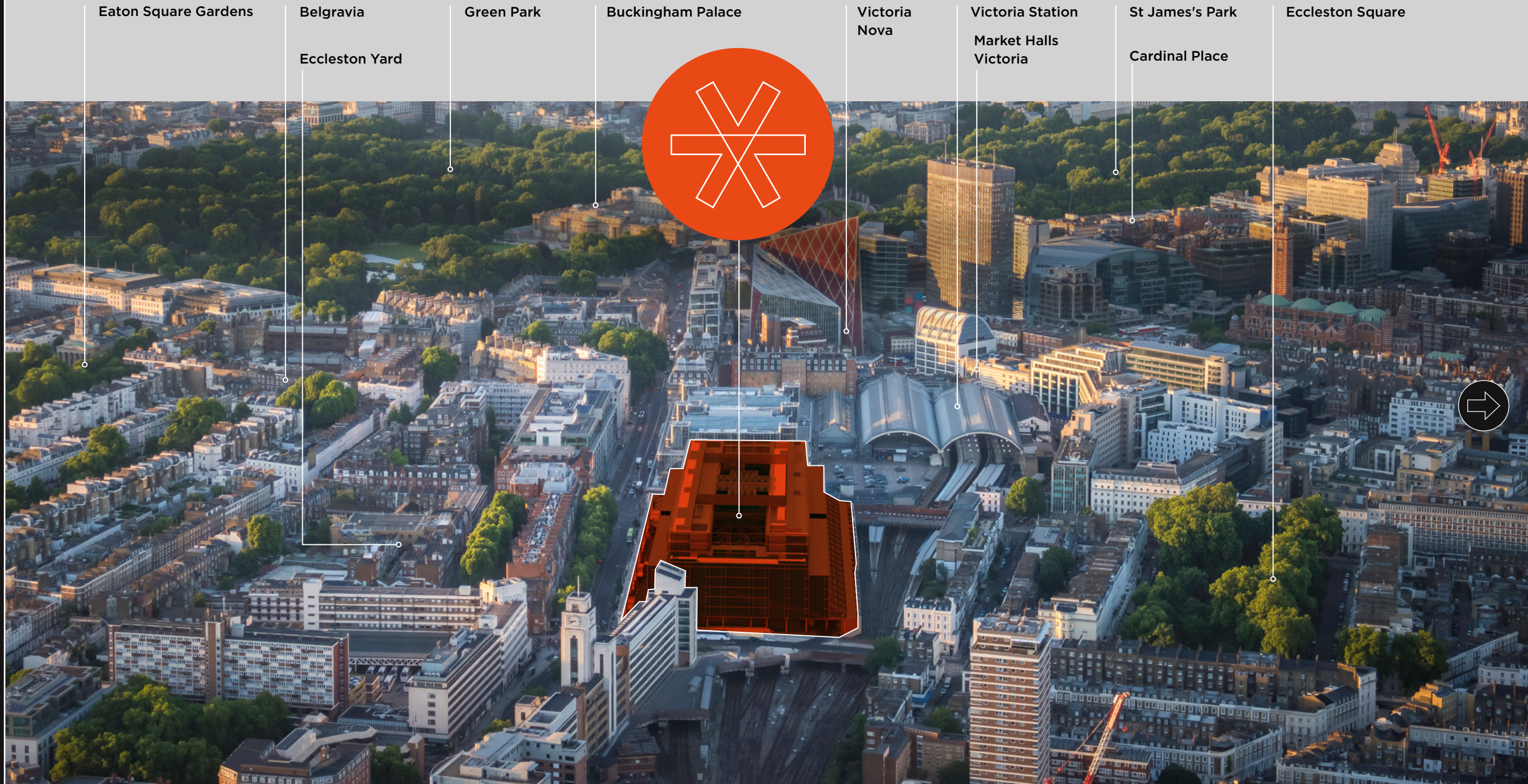

207,000 people pass through Victoria Station every day



Introduction

Your Neighbourhood

Location

Area Map

Site Plan

Retail Units

Contact





Introduction

Your Neighbourhood

Location

Area Map

Site Plan

Retail Units

Contact





Introduction

Your Neighbourhood

Location

Area Map

Site Plan

Retail Units

Contact

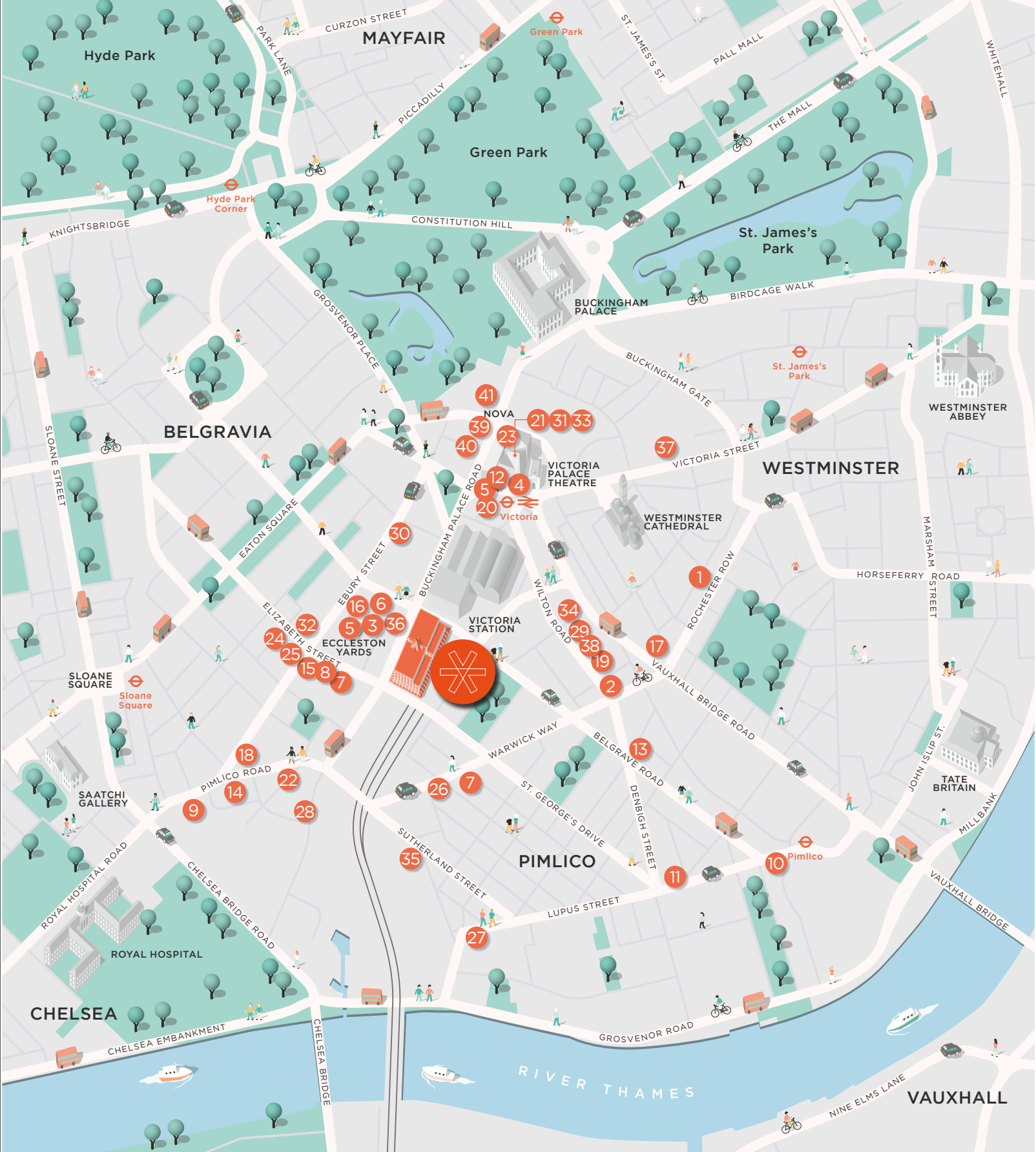

FOOD & DRINK

RETAILERS

LEISURE

Food & Drink

RESTAURANTS, CAFÉS & BARS

- | | |
|------------------------------|---------------------------|
| 01. 2 Amici | 22. No 11 Pimlico Road |
| 02. About Thyme | 23. Ole & Steen |
| 03. Atis | 24. Olivocarne |
| 04. Aster | 25. Peggy Porschen Cakes |
| 05. Bleecker Burger | 26. The Pimlico Grid |
| 06. Boisdale of Belgravia | 27. Pimlico Spice |
| 07. Cambridge Street Kitchen | 28. The Rising Sun |
| 08. Chestnut Bakery | 29. Rosa's Thai Cafe |
| 09. Enoteca Turi | 30. Santini |
| 10. The Gallery | 31. Sticks 'n' Sushi |
| 11. Goya | 32. The Thomas Cubitt |
| 12. Greenwood | 33. Timmy Green |
| 13. Grumbles | 34. Tozi |
| 14. Hunan | 35. The White Ferry House |
| 15. Il Convivio | 36. Wild by Tart |
| 16. Jones Family Kitchen | 37. The Ivy Victoria |
| 17. The Jugged Hare | 38. A Wong |
| 18. La Poule au Pot | 39. Pizza Pilgrims |
| 19. Lorne | 40. Pullbrook & Gould |
| 20. Market Halls Victoria | 41. Singapulah |
| 21. Nova Food | |





Introduction

Your Neighbourhood

Location

Area Map

Site Plan

Retail Units

Contact

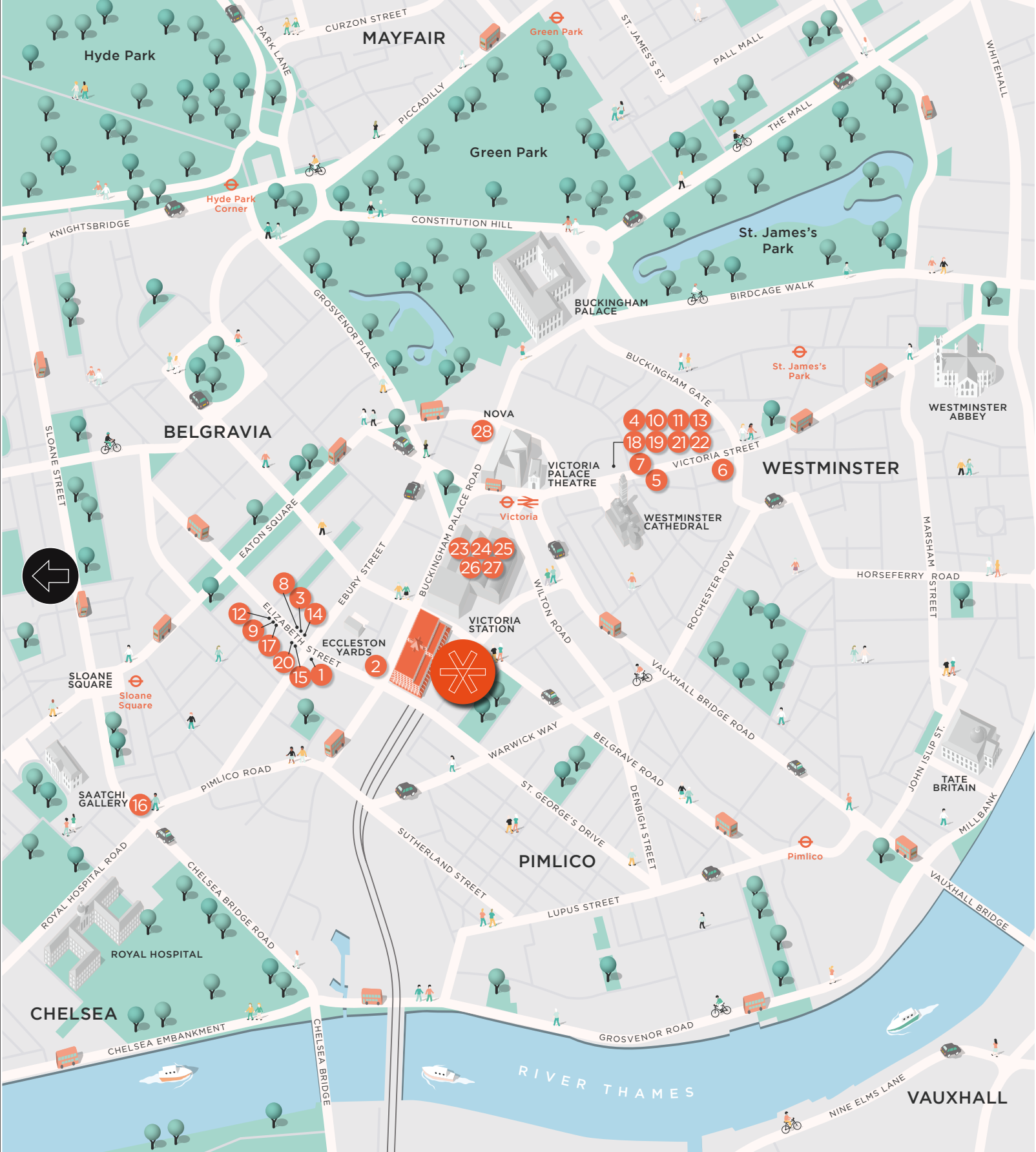

FOOD & DRINK

RETAILERS

LEISURE

Retailers

RETAILERS

- 01. Bayley & Sage
- 02. Black Sheep Coffee
- 03. Donna Ida
- 04. Hobbs
- 05. Hotel Chocolat
- 06. House of Fraser
- 07. Hugo Boss
- 08. Jo Loves
- 09. Les Senteurs
- 10. L'Occitane
- 11. Molton Brown
- 12. Mungo & Maud
- 13. Nespresso
- 14. NRBY Clothing
- 15. Papouelli
- 16. Potterton Books
- 17. Philip Treacy
- 18. Runners Need
- 19. Space NK
- 20. Stivaleria Cavallin
- 21. T2 Tea
- 22. Zara
- 23. Sainsbury's
- 24. Holland and Barrett
- 25. Marks & Spencer
- 26. Scribbler
- 27. Hema
- 28. Maison Beaute





Introduction
Your Neighbourhood
Location
Area Map
Site Plan
Retail Units
Contact

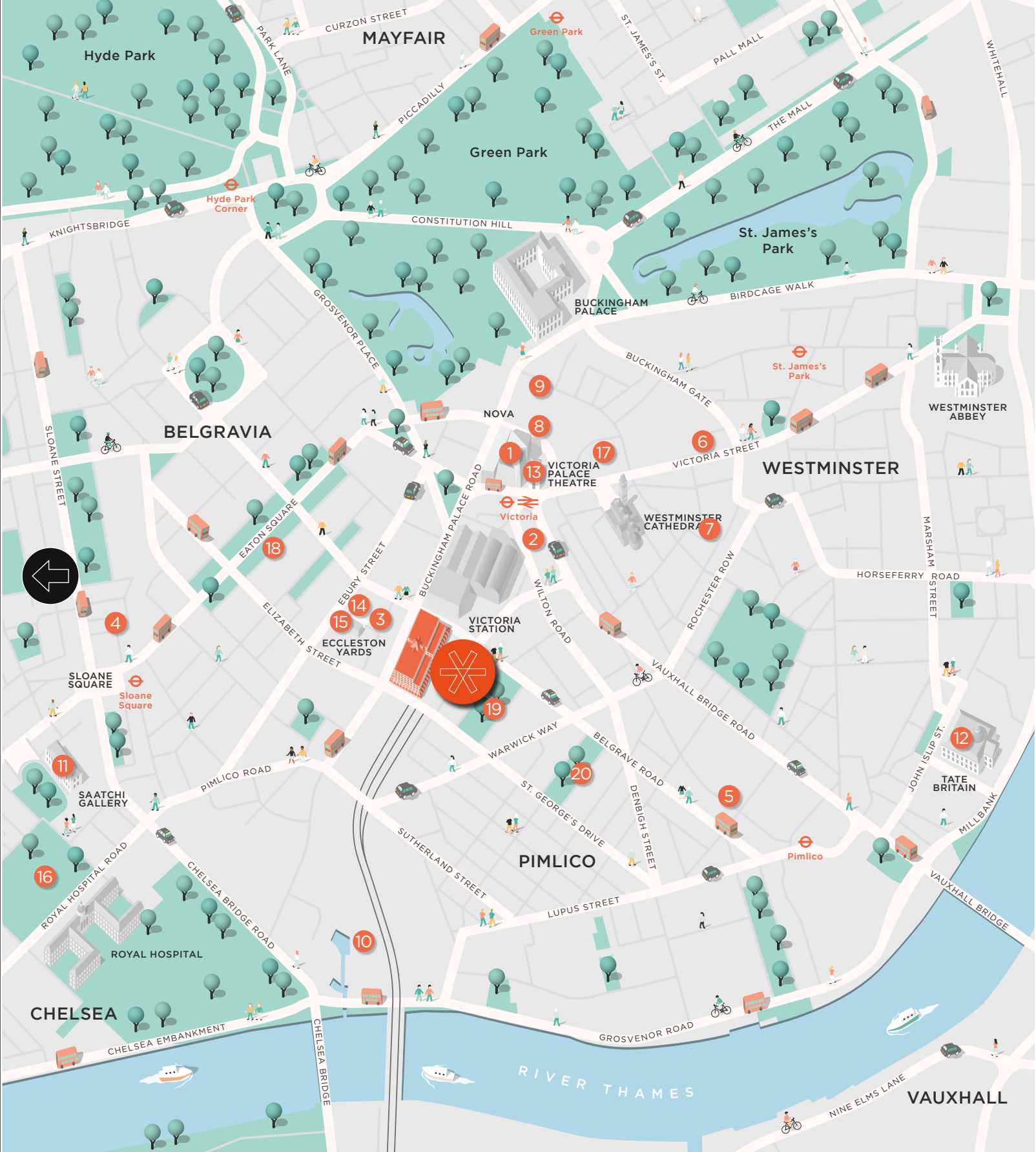

FOOD & DRINK
RETAILERS
LEISURE

Leisure

- LEISURE**
- 01. 1Rebel
 - 02. Apollo Victoria Theatre
 - 03. Barry's
 - 04. Cadogan Hall
 - 05. Cave
 - 06. Curzon Cinema
 - 07. Gymbox
 - 08. H2 Club
 - 09. The Other Palace Theatre
 - 10. Purple Dragon
 - 11. Saatchi Gallery
 - 12. Tate Britain
 - 13. Victoria Palace Theatre
 - 14. Light Centre Belgravia
 - 15. Re:Mind Meditation

- GREEN SPACES**
- 16. Burton Court
 - 17. Cardinal Place Roof Garden
 - 18. Eaton Square Gardens
 - 19. Eccleston Square
 - 20. Warwick Square



Site Plan

- Units
- Public Realm
- Atriums
- Loading Bays

- Introduction
- Your Neighbourhood
- Site Plan
- Retail Units
- Contact

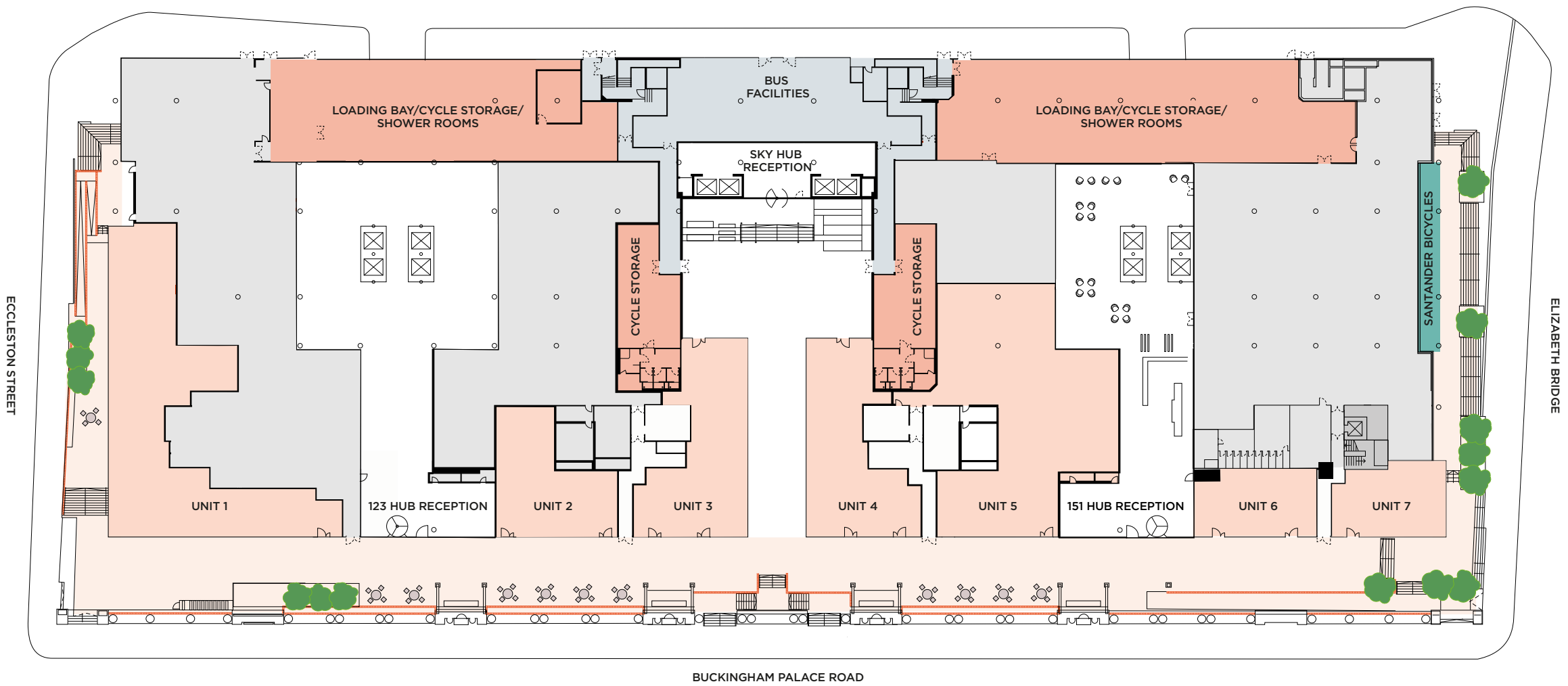



Introduction
Your Neighbourhood
Site Plan
Retail Units
Unit 1
Unit 2
Unit 3
Unit 4
Unit 5
Unit 6
Unit 7
Contact

Unit 1

463 sq m / 4,983 sq ft

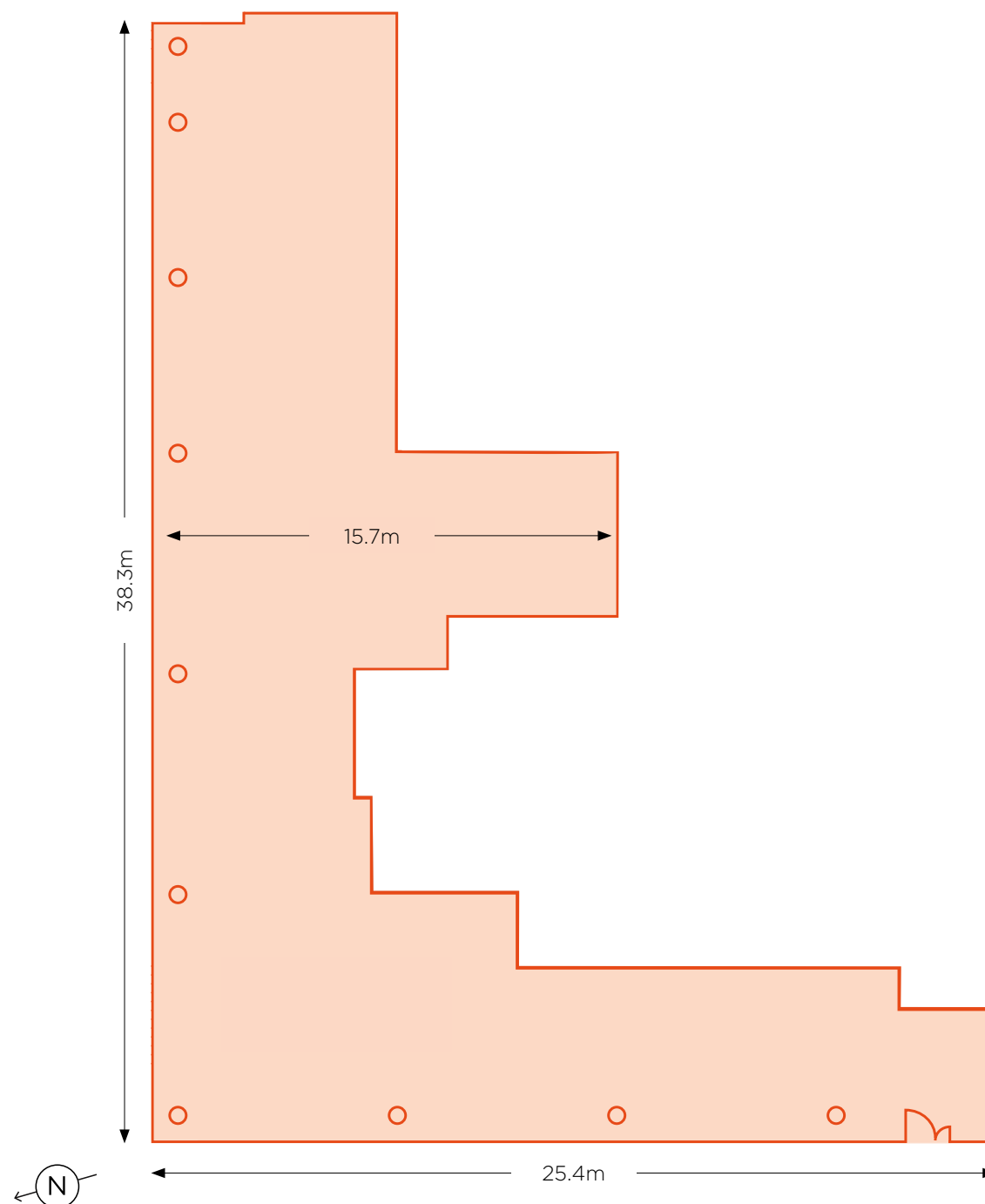

UNIT NUMBER	The HUB Unit 1
PERMITTED USE:	Class E (A1/A3/A4)
AREA (NIA):	463 sq m
FLOOR FINISH:	115mm Finishes zone above concrete slab
FLOOR TO CEILING:	Minimum 3100mm
CEILING FINISH:	Exposed services
SHOP FRONT:	Laminated low iron glazing
WATER SUPPLY:	32mm supply
GAS SUPPLY:	65mm supply available
ELECTRICITY SUPPLY:	300A TP&N
EXTRACTION:	Capacity for duct 600x600mm
HEATING/HOT WATER:	Managed by tenant
COOLING:	Managed by tenant
DRAIN CONNECTIONS:	Pumped drainage by tenant

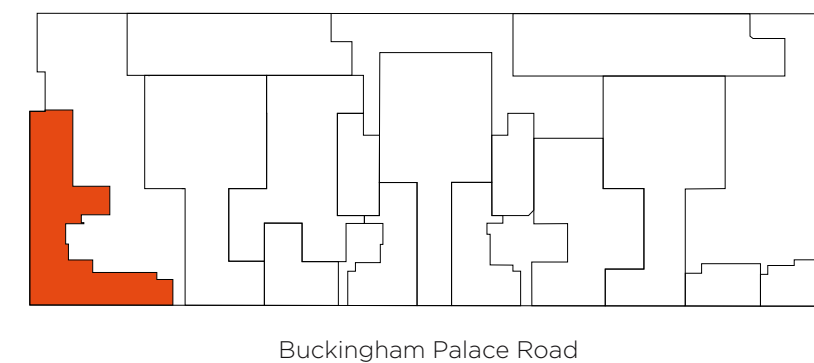

Buckingham Palace Road



Unit 2

173 sq m / 1,862 sq ft

- Introduction
- Your Neighbourhood
- Site Plan
- Retail Units**
- Unit 1
- Unit 2**
- Unit 3
- Unit 4
- Unit 5
- Unit 6
- Unit 7
- Contact

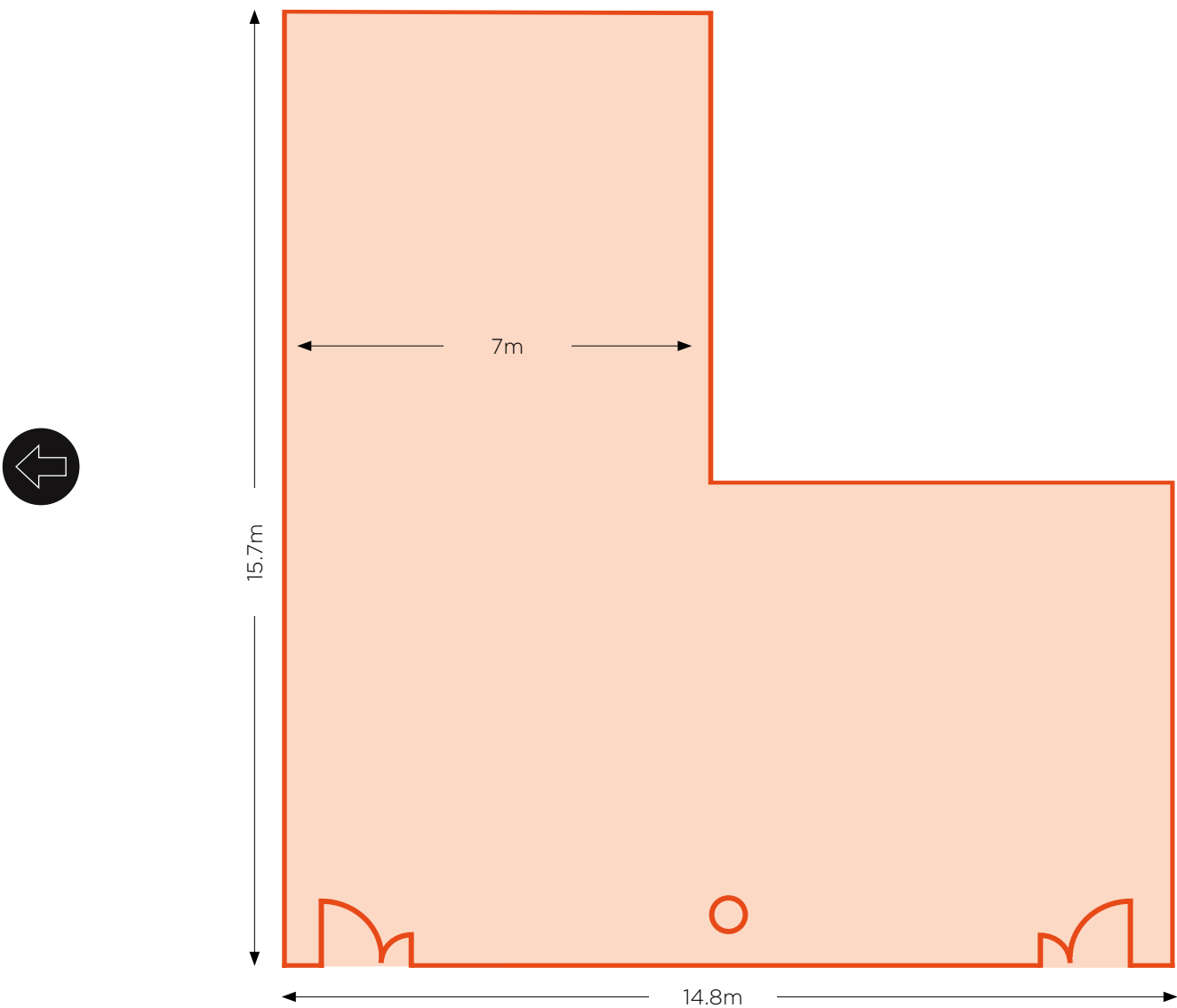

UNIT NUMBER	The HUB Unit 2
PERMITTED USE:	Class E (A1/A3/A4)
AREA (NIA):	173 sq m
FLOOR FINISH:	115mm Finishes zone above concrete slab
FLOOR TO CEILING:	Minimum 3100mm
CEILING FINISH:	Exposed services
SHOP FRONT:	Laminated low iron glazing
WATER SUPPLY:	28mm supply
GAS SUPPLY:	Not available
ELECTRICITY SUPPLY:	100A TP&N
HEATING/HOT WATER:	Managed by tenant
COOLING:	Managed by tenant
DRAIN CONNECTIONS:	Pumped drainage by tenant

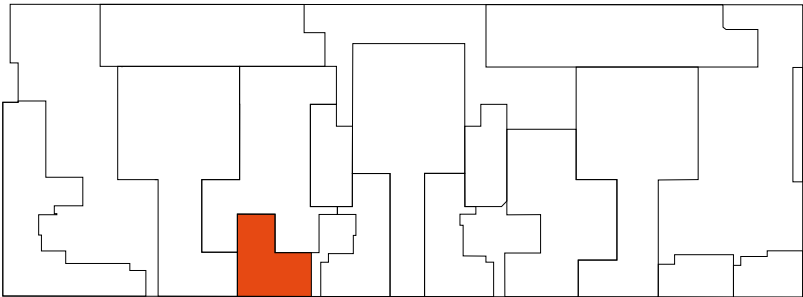

Buckingham Palace Road



- Introduction
- Your Neighbourhood
- Site Plan
- Retail Units**
- Unit 1
- Unit 2
- Unit 3**
- Unit 4
- Unit 5
- Unit 6
- Unit 7
- Contact

Unit 3

232 sq m / 2,497 sq ft

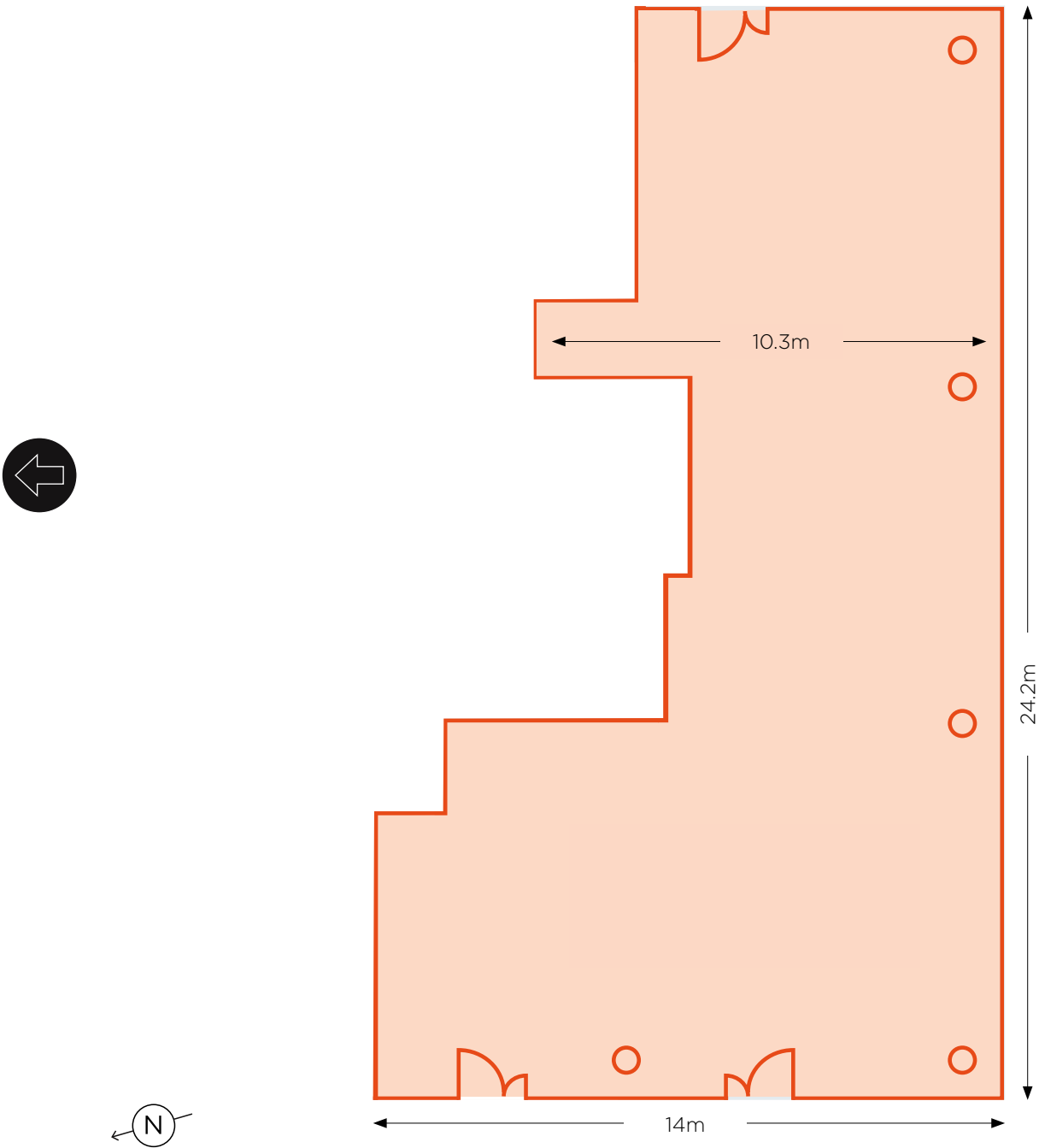

UNIT NUMBER	The HUB Unit 3
PERMITTED USE:	Class E (A1/A3/A4)
AREA (NIA):	232 sq m
FLOOR FINISH:	115mm Finishes zone above concrete slab
FLOOR TO CEILING:	Minimum 3100mm
CEILING FINISH:	Exposed services
SHOP FRONT:	Laminated low iron glazing
WATER SUPPLY:	32mm supply
GAS SUPPLY:	65mm supply available
ELECTRICITY SUPPLY:	200A TP&N
EXTRACTION:	Capacity for duct 600x600mm
HEATING/HOT WATER:	Managed by tenant
COOLING:	Managed by tenant
DRAIN CONNECTIONS:	Pumped drainage by tenant

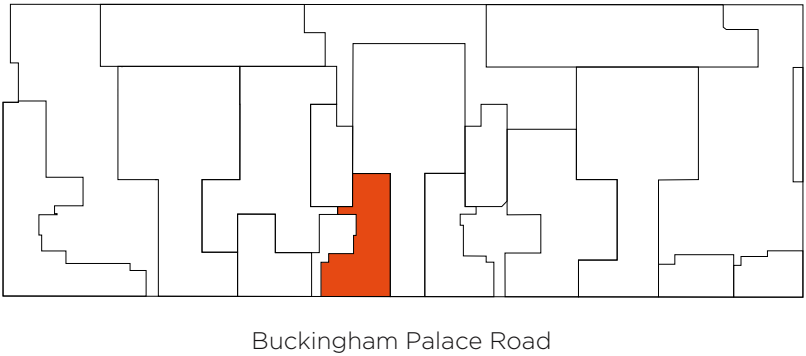



Unit 4

232 sq m / 2,497 sq ft

- Introduction
- Your Neighbourhood
- Site Plan
- Retail Units**
- Unit 1
- Unit 2
- Unit 3
- Unit 4**
- Unit 5
- Unit 6
- Unit 7
- Contact

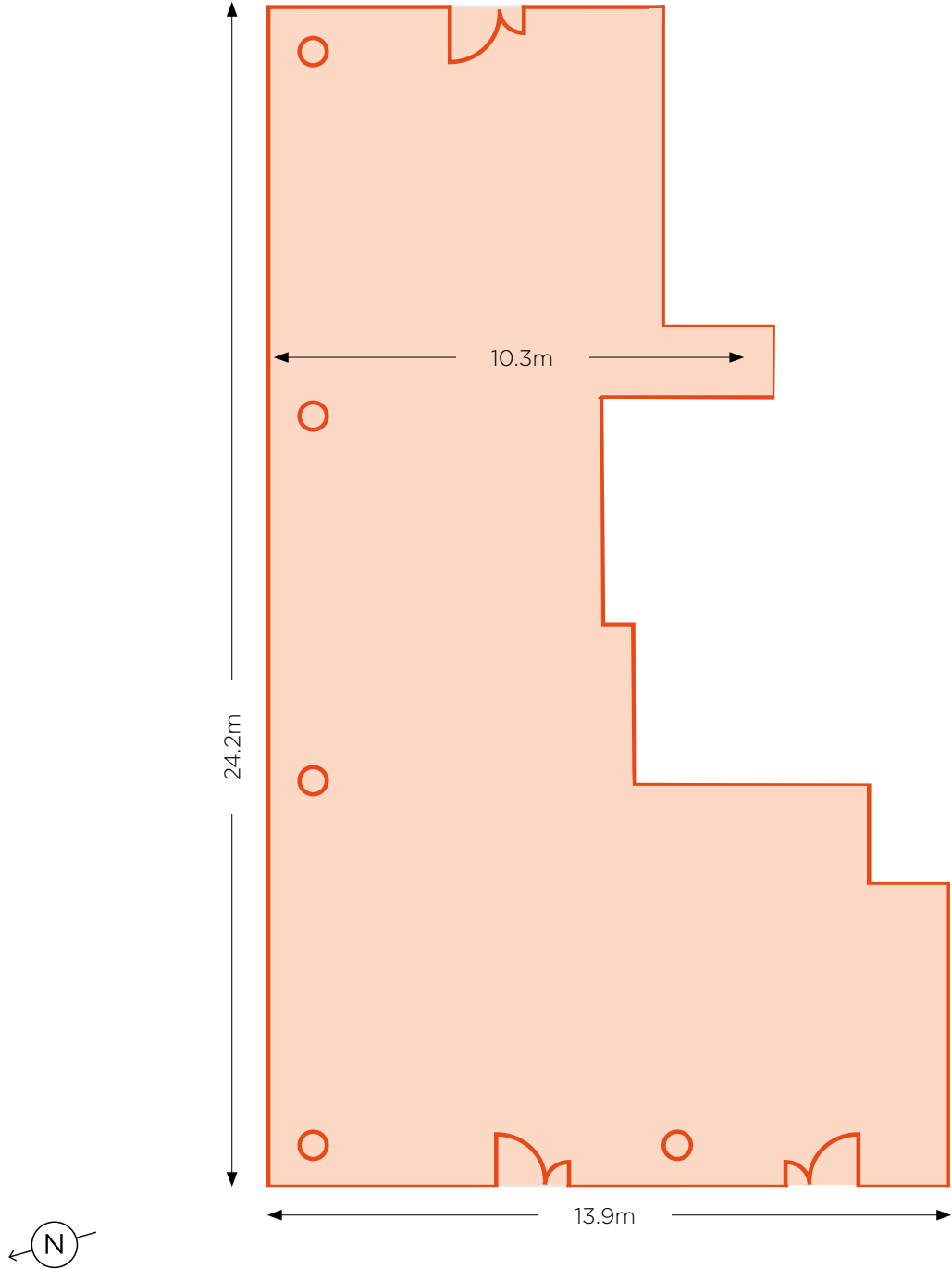

UNIT NUMBER	The HUB Unit 4
PERMITTED USE:	Class E (A1/A3/A4)
AREA (NIA):	232 sq m
FLOOR FINISH:	115mm Finishes zone above concrete slab
FLOOR TO CEILING:	Minimum 3100mm
CEILING FINISH:	Exposed services
SHOP FRONT:	Laminated low iron glazing
WATER SUPPLY:	28mm supply
GAS SUPPLY:	Not available
ELECTRICITY SUPPLY:	200A TP&N
HEATING/HOT WATER:	Managed by tenant
COOLING:	Managed by tenant
DRAIN CONNECTIONS:	Pumped drainage by tenant

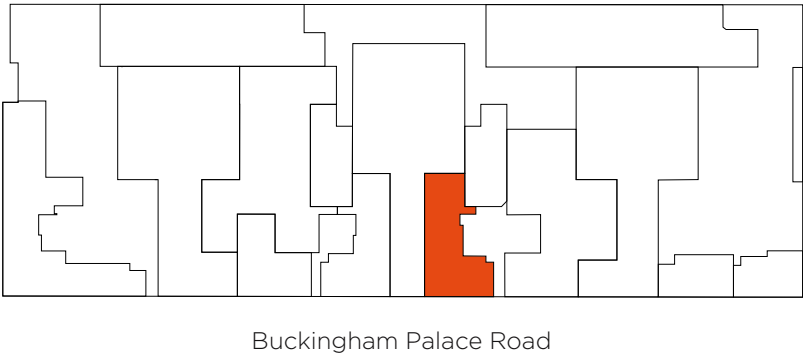



- Introduction
- Your Neighbourhood
- Site Plan
- Retail Units**
 - Unit 1
 - Unit 2
 - Unit 3
 - Unit 4
 - Unit 5**
 - Unit 6
 - Unit 7
- Contact

Unit 5

483 sq m / 5,198 sq ft

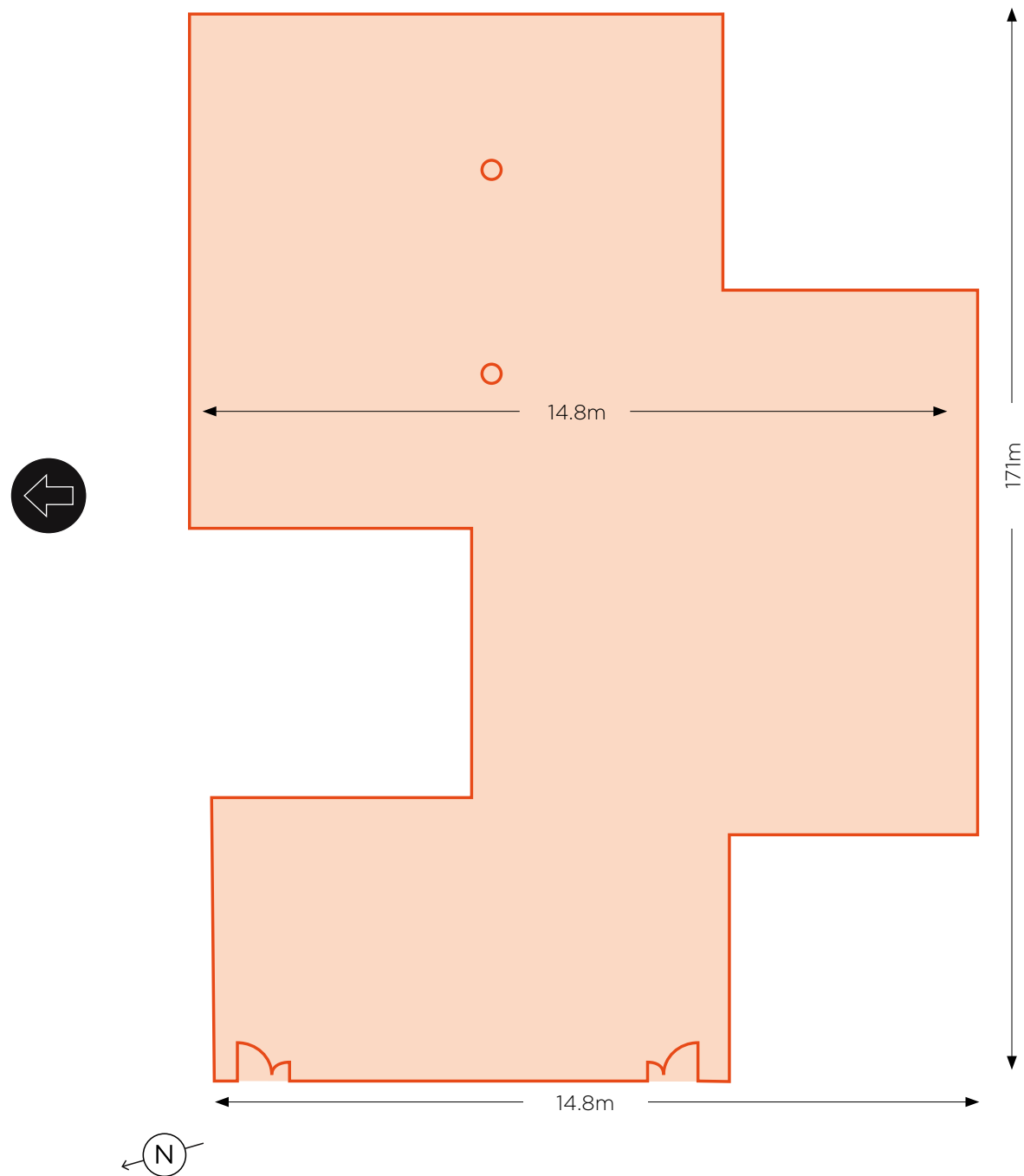

UNIT NUMBER	The HUB Unit 5
PERMITTED USE:	Class E (D2)
AREA (NIA):	483 sq m
FLOOR FINISH:	115mm Finishes zone above concrete slab
FLOOR TO CEILING:	Minimum 3100mm
CEILING FINISH:	Exposed services
SHOP FRONT:	Laminated low iron glazing
WATER SUPPLY:	28mm supply
GAS SUPPLY:	Not available
ELECTRICITY SUPPLY:	100A TP&N
HEATING/HOT WATER:	Managed by tenant
COOLING:	Managed by tenant
DRAIN CONNECTIONS:	Pumped drainage by tenant

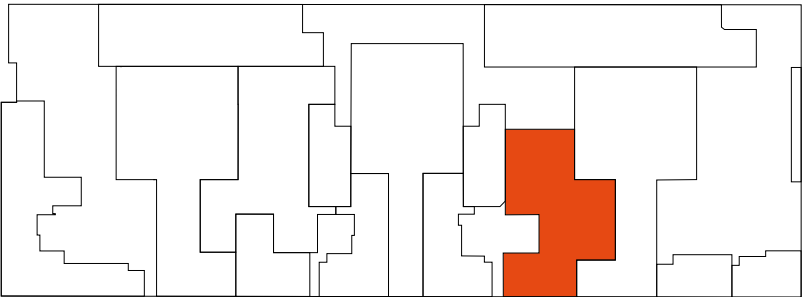

Buckingham Palace Road



Unit 6

115 sq m / 1,237 sq ft

- Introduction
- Your Neighbourhood
- Site Plan
- Retail Units**
- Unit 1
- Unit 2
- Unit 3
- Unit 4
- Unit 5
- Unit 6**
- Unit 7
- Contact

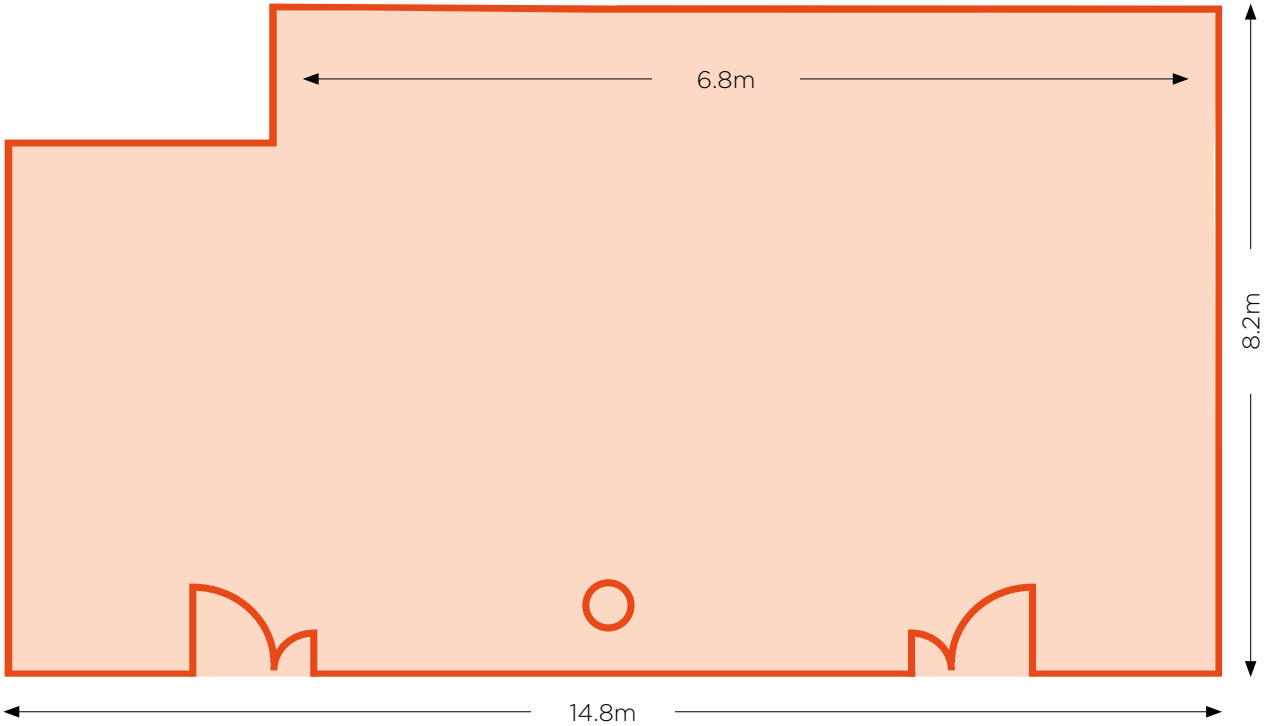

UNIT NUMBER	The HUB Unit 6
PERMITTED USE:	Class E (A1/A3/A4)
AREA (NIA):	115 sq m
FLOOR FINISH:	115mm Finishes zone above concrete slab
FLOOR TO CEILING:	Minimum 3100mm
CEILING FINISH:	Exposed services
SHOP FRONT:	Laminated low iron glazing
WATER SUPPLY:	28mm supply
GAS SUPPLY:	Not available
ELECTRICITY SUPPLY:	100A TP&N
HEATING/HOT WATER:	Managed by tenant
COOLING:	Managed by tenant
DRAIN CONNECTIONS:	Pumped drainage by tenant

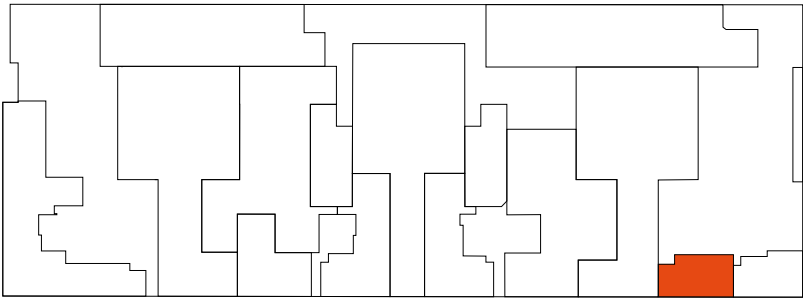

Buckingham Palace Road



Unit 7

117 sq m / 1,259 sq ft

- Introduction
- Your Neighbourhood
- Site Plan
- Retail Units**
- Unit 1
- Unit 2
- Unit 3
- Unit 4
- Unit 5
- Unit 6
- Unit 7**
- Contact

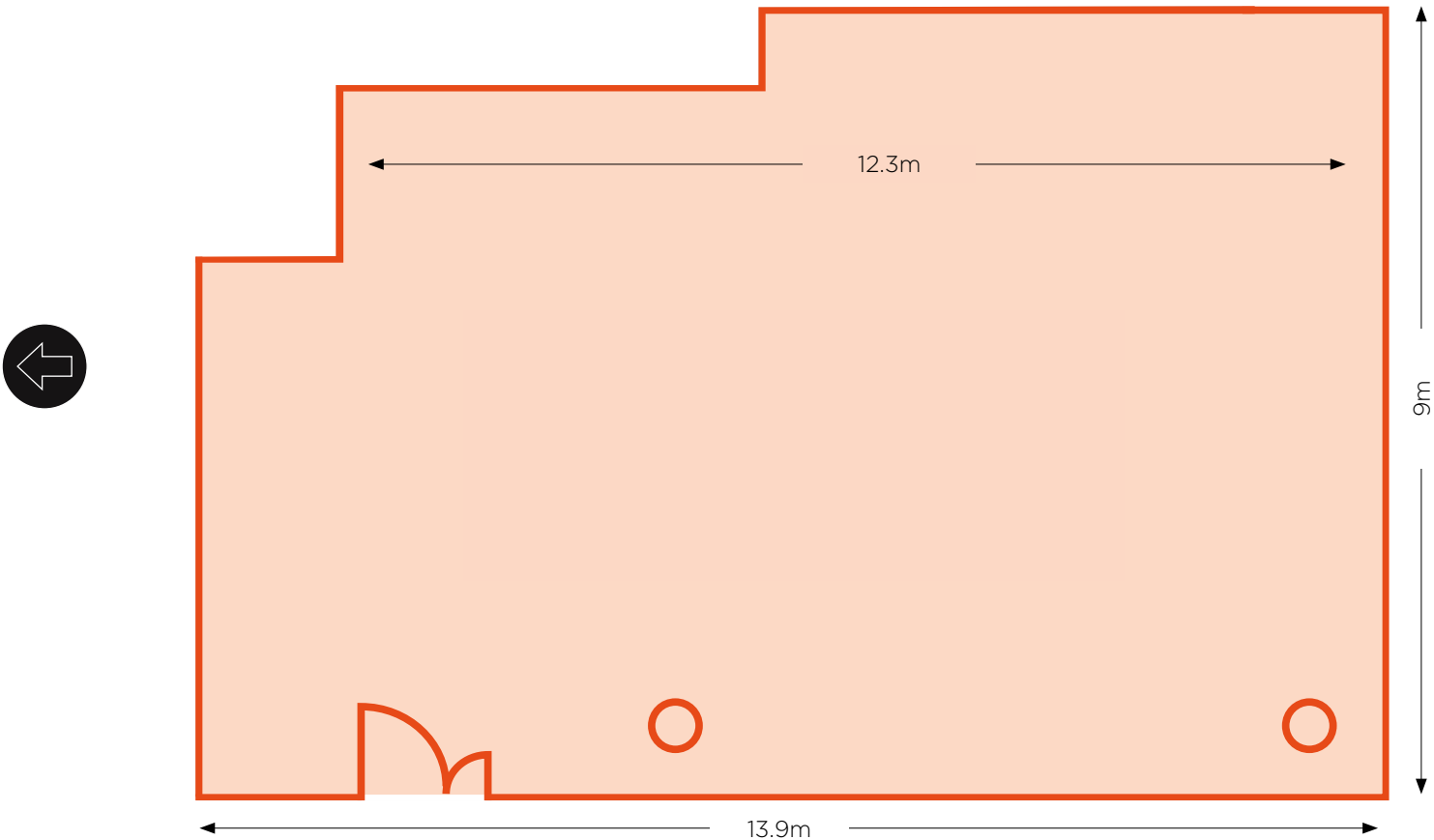

UNIT NUMBER	The HUB Unit 7
PERMITTED USE:	Class E (A1/A3/A4)
AREA (NIA):	117 sq m
FLOOR FINISH:	115mm Finishes zone above concrete slab
FLOOR TO CEILING:	Minimum 3100mm
CEILING FINISH:	Exposed services
SHOP FRONT:	Laminated low iron glazing
WATER SUPPLY:	28mm supply
GAS SUPPLY:	Not available
ELECTRICITY SUPPLY:	100A TP&N
HEATING/HOT WATER:	Managed by tenant
COOLING:	Managed by tenant
DRAIN CONNECTIONS:	Pumped drainage by tenant

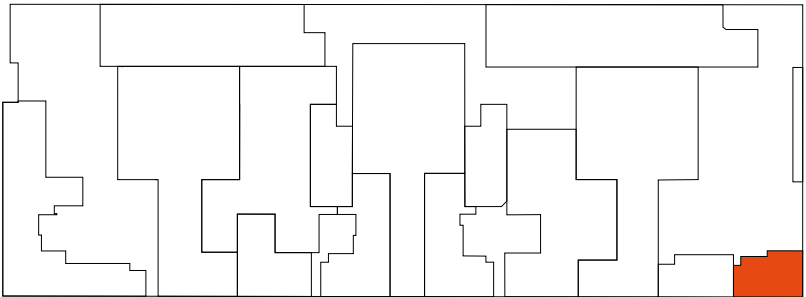

Buckingham Palace Road

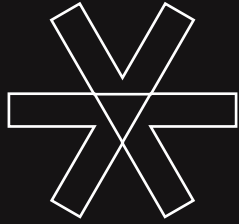

Introduction

Your Neighbourhood

Site Plan

Retail Units

Contact

TEAM

ASSET MANAGER
Gaw Capital

ARCHITECT
Morrow & Lorraine

BUILDING AND FACILITIES MANAGER
Colliers International

PROJECT MANAGERS
Buro Four

**RETAIL LEASING
ENQUIRIES**



SUSIE BUSS
M +44(0) 7807 079 971
Susie.buss@eu.jll.com

DAVID CARLSSON
M +44(0) 7904 949 275
David.carlsson@eu.jll.com

LL for themselves and for the vendors or lessors of this property whose agents they are, give notice that:- a. the particulars are set out as a general outline only for guidance and do not constitute, nor constitute part of, an offer or contract; b. all descriptions, dimensions, references to condition and necessary permissions for use and occupation, and other details are believed to be correct, but any intending purchasers, tenants or third parties should not rely on them as statements or representations of fact but satisfy themselves that they are correct by inspection or otherwise; c. All properties are measured in accordance with the RICS property measurement, 1st Edition May 2015 (incorporating IPMS) unless designated NIA/GIA/GEA, in which case properties are measured in accordance with the RICS Code of Measuring Practice (6th Edition); d. Any images may be computer generated. Any photographs show only certain parts of the property as they appeared at the time they were taken. © 2021

